

UNL Trainers for Onsite Wastewater Treatment

Wayne Woldt and Jan Hygnstrom, UNL Extension, will team teach all classes.



Onsite Wastewater Training Form

Complete and detach the registration form for Pumps & Controls and Dosed Systems training. Mail the registration form and a check made out to the "University of Nebraska" to:

Connie Hansen
102 Mussehl Hall
Lincoln, NE 68583-0714

• • • • •
SPACE IS LIMITED . . . SO REGISTER EARLY!

Registrations must be postmarked at least THREE WEEKS prior to the session. Classes are limited to 30 attendees.

UNL reserves the right to cancel training if there are insufficient registrations.

Don't wait, register today!



REGISTRATION: If you have questions regarding the registration for training, or have special meal requirements, please call Connie at 402-472-3674.

DIRECTIONS

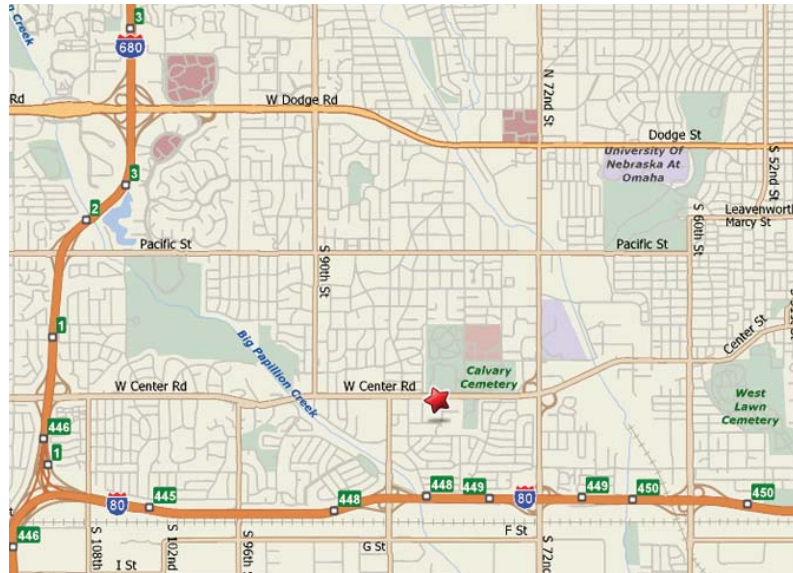

Douglas County Extension Central Office
8015 West Center Road
Omaha, NE
Phone: 402-444-7804

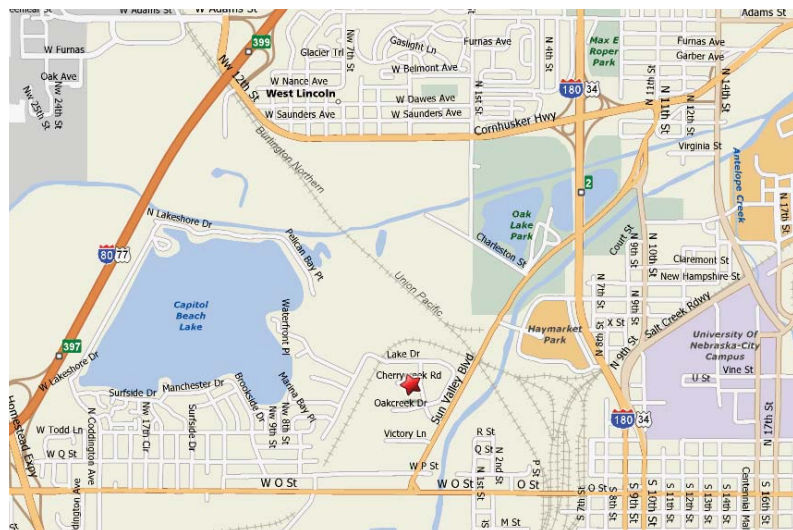

Lancaster County Extension Office
444 Cherrycreek Road
Lincoln, NE
Phone: 402-441-7180

University of Nebraska–Lincoln Extension

Late Fall
2009

Onsite Wastewater Treatment

CONTINUING EDUCATION TRAINING

Day 1: PUMPS & CONTROLS

9:00 am to 4:30 pm = 6 CEUs

Day 2: DOSED SYSTEMS

9:00 am - 4:30 pm = 6 CEUs

CHOOSE THE DATES AND LOCATIONS
BEST FOR YOUR SCHEDULE:

November 4 & 5

Douglas County Extension Office
8015 West Center Road
Omaha, NE

December 2 & 3

Lancaster County Extension Office
444 Cherrycreek Road
Lincoln, NE

LIMITED SEATING!

Will you have your 12 professional
development hours prior to the
December 31, 2009 deadline?

Earn CEUs!

<http://water.unl.edu/sewage>

CONTINUING EDUCATION TRAINING

Presentations, discussion and interaction on concepts and science behind the pump sizing and selection, installation, dosing, and maintenance will be the foundation for these training sessions. Participants of all sessions will be able to apply their experience and knowledge about onsite systems to new issues. **Participants must attend Pumps and Controls prior to attending Dosed Systems.**

Pumps and dosed systems are allowed in Nebraska, and even required for systems with greater than 500 linear feet of distribution line (Title 124, pg 14-12). This information will be valuable for certified installers who must deal with large drainfields, or who cannot use gravity flow for systems due to lack of appropriate elevation changes.

DAILY TRAINING SCHEDULE

- 8:30 Sign in
- 9:00 Training begins
- 4:30 Training adjourns

Lunch and break refreshments are provided at the training site.

NOWWA member - \$140.00* each day
(NOWWA - Nebraska Onsite Waste Water Association)

Non-NOWWA member - \$160.00 each day

Each UNL Extension workshop offers 6 hours of training, lunch, refreshments at breaks, a training manual*, and an attendance certificate for each person. Registration fee includes all of the above.

*NOWWA is responsible for production and distribution of the required training manual. They are underwriting a portion of the registration fee, which reduces the cost of their members' manuals. **If you are interested in becoming a NOWWA member, please call Diane Snapp at 402-476-0162.**

DAY 1: PUMPS & CONTROLS

Earn up to 6.0 professional development hours toward continuing education requirements. This course must be taken prior to taking DAY 2: DOSED SYSTEMS.

TOPICS . . .

| | |
|---|---------------------------|
| Intro to pumps in onsite wastewater treatment systems | |
| Siphons | Types of pumps |
| Pump selection | Pump controls |
| Demonstrations/Displays | Operation and Maintenance |

DAY 2: DOSED SYSTEMS

Prerequisite: DAY 1: PUMPS & CONTROLS

Earn up to 6.0 professional development hours toward continuing education requirements.

TOPICS . . .

| | |
|-------------------------|--|
| Why dose? | Setting up distribution for dose to gravity flow |
| Dose tanks | Installation considerations |
| Operation & Maintenance | |

CANCELLATIONS

You will receive confirmation that you have been registered. Any cancellations received six or more business days (Monday through Friday) before the training will receive a full refund. Cancellations received 2 to 5 business days before the training date will receive a partial refund - a \$25 per person service charge will be withheld. No refunds will be given for "No shows" or cancellations received one business day prior to training.

University of Nebraska-Lincoln Extension educational programs abide with the nondiscrimination policies of the University of Nebraska-Lincoln and the United States Department of Agriculture. UNL assures reasonable facilities and accommodations under the Americans with Disabilities Act. For special needs contact Connie at 402-472-3674.

UNL Extension Onsite Wastewater 2009 November/December Training Registration Form

Photocopy this form for additional registrations.

Name _____

Company _____

Address _____

City _____ State _____ Zip _____

Phone _____

E-mail _____

Check the training session(s) that you will attend.

- ___ Omaha: November 4 - Pumps & Controls
- ___ Omaha: November 5 - Dosed Systems
- ___ Lincoln: December 2 - Pumps & Controls
- ___ Lincoln: December 3 - Dosed Systems

Total Registration Fee \$ _____

NOWWA member: \$140.00* each day
Non-NOWWA member: \$160.00 each day

*NOWWA is responsible for production and distribution of the required training manuals. As a result, NOWWA is offering member discounts for training manuals.

Make your check payable to the "University of Nebraska" and send registration form and check to:

Connie Hansen
102 Mussehl Hall
Lincoln, NE 68583-0714

For questions regarding training, call Connie at 402-472-3674. You will receive a confirmation letter and map upon receipt of your check.

